

Courses and Dis.  
Down the Creek

- s 80 e 72 Perches
- s 50 e 50
- s 16 e 46
- s 24 w 22
- s 40 w 32
- s 25 e 26
- s 50 e 26
- w 79 e 66
- s 45 e 22
- s 9 w 52

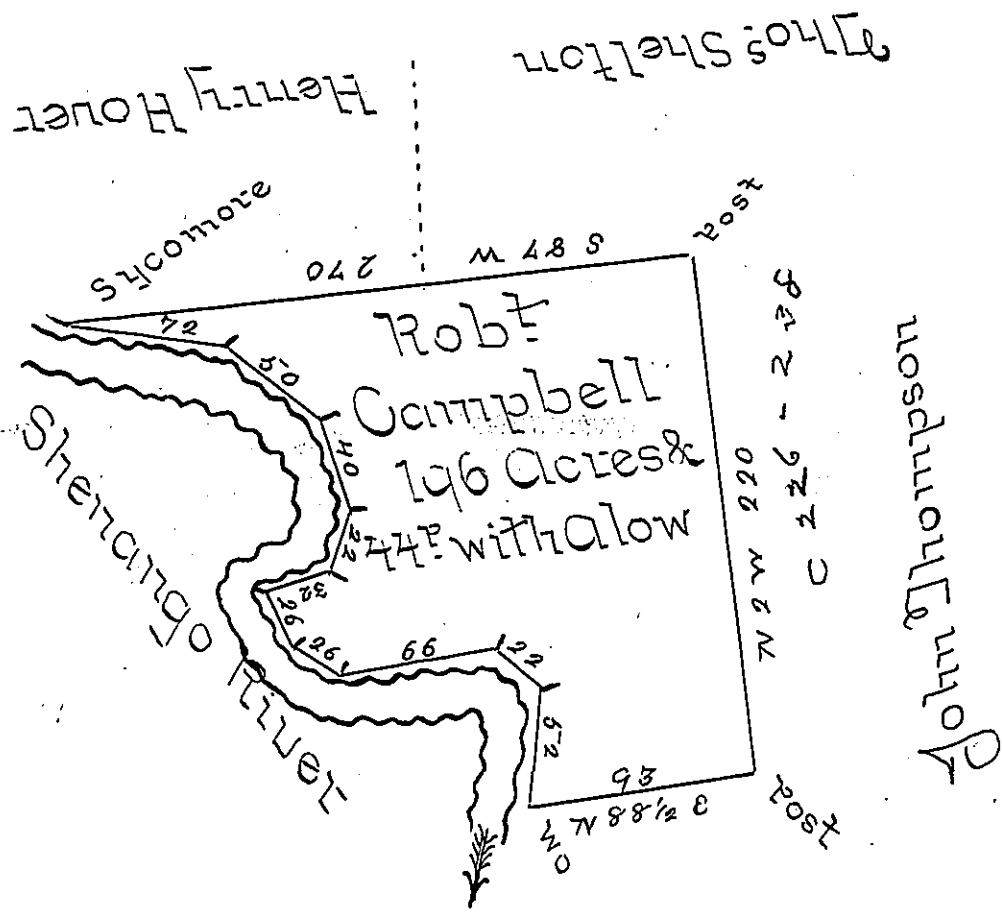

James Campbell

Situate on the east side of Big Shenango in Neshamoking Township Mercer County containing one hundred and ninety six acres and forty four Perches with Allowance of six per cent &c. Surveyed May 4<sup>th</sup> 1802 in pursuance of a Warrant granted to Robert Campbell Dated the 22<sup>nd</sup> Day of Jan<sup>y</sup> 1802

John Findley D.S.

To Samuel Cochran Esq<sup>r</sup> S<sup>r</sup>.

IN TESTIMONY that the above is a copy of the original remaining on file in the Department of Internal Affairs of Pennsylvania, made conformably to an Act of Assembly approved the 16th day of February, 1833, I have hereunto set my Hand and caused the Seal of said Department to be affixed at Harrisburg, this sixth day of February 1900.

*James W. Latta*  
Secretary of Internal Affairs.